

4
AS
DETAIL BETWEEN PAVS

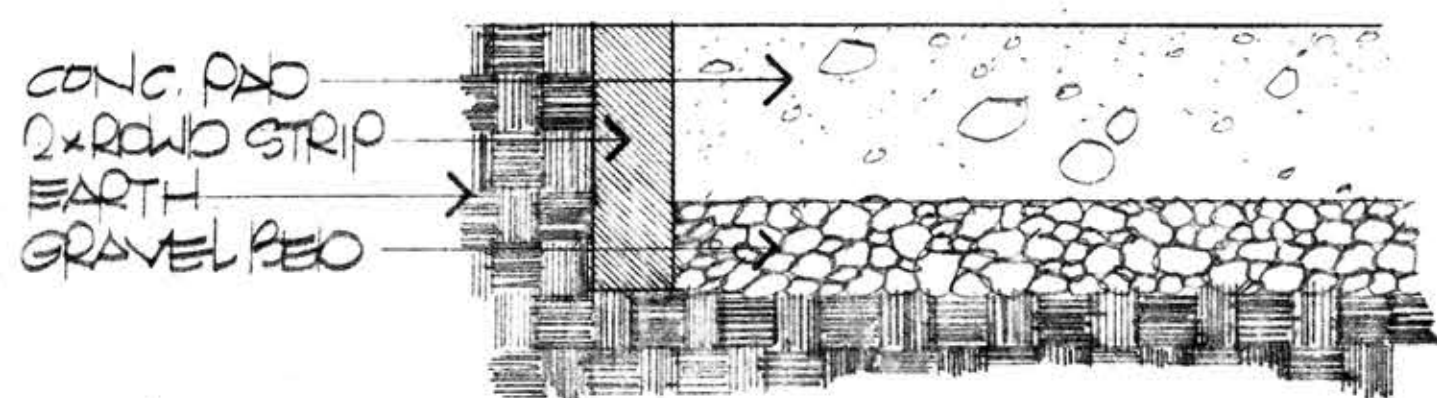

5
AS
DETAIL AT PAD EDGE

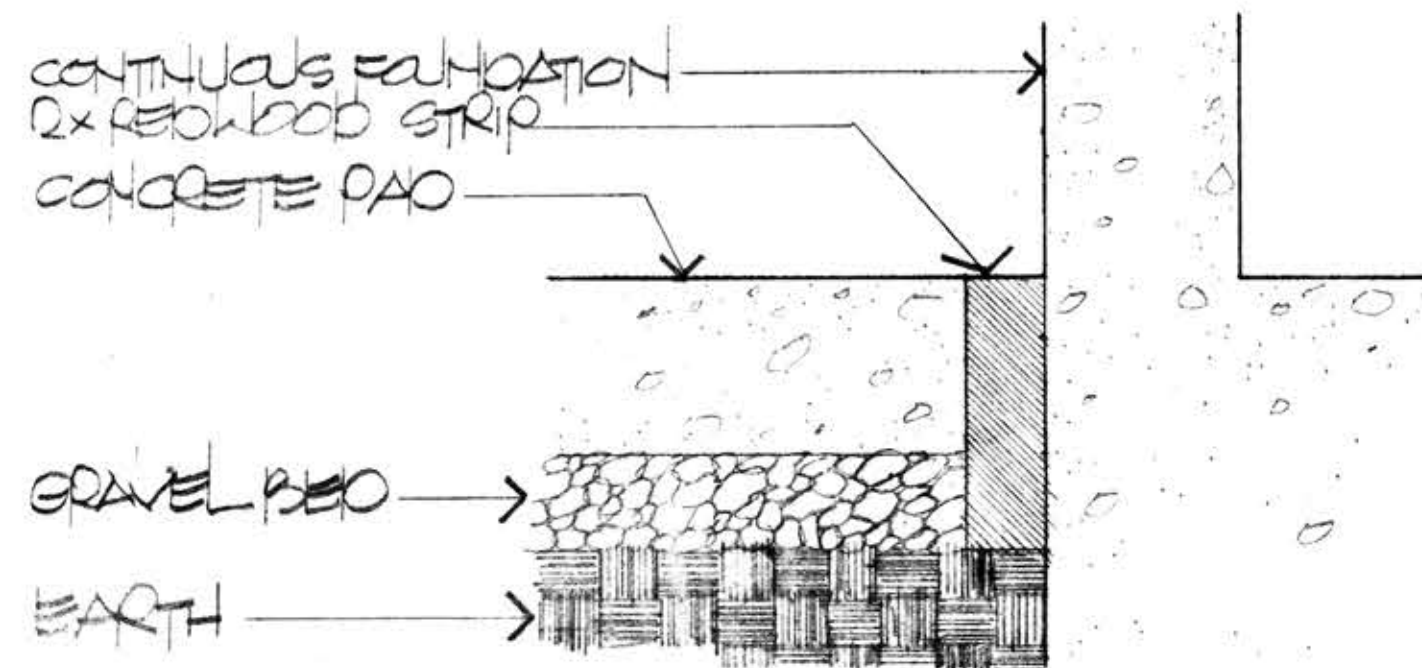

6
AS
DETAIL AT BUILDING

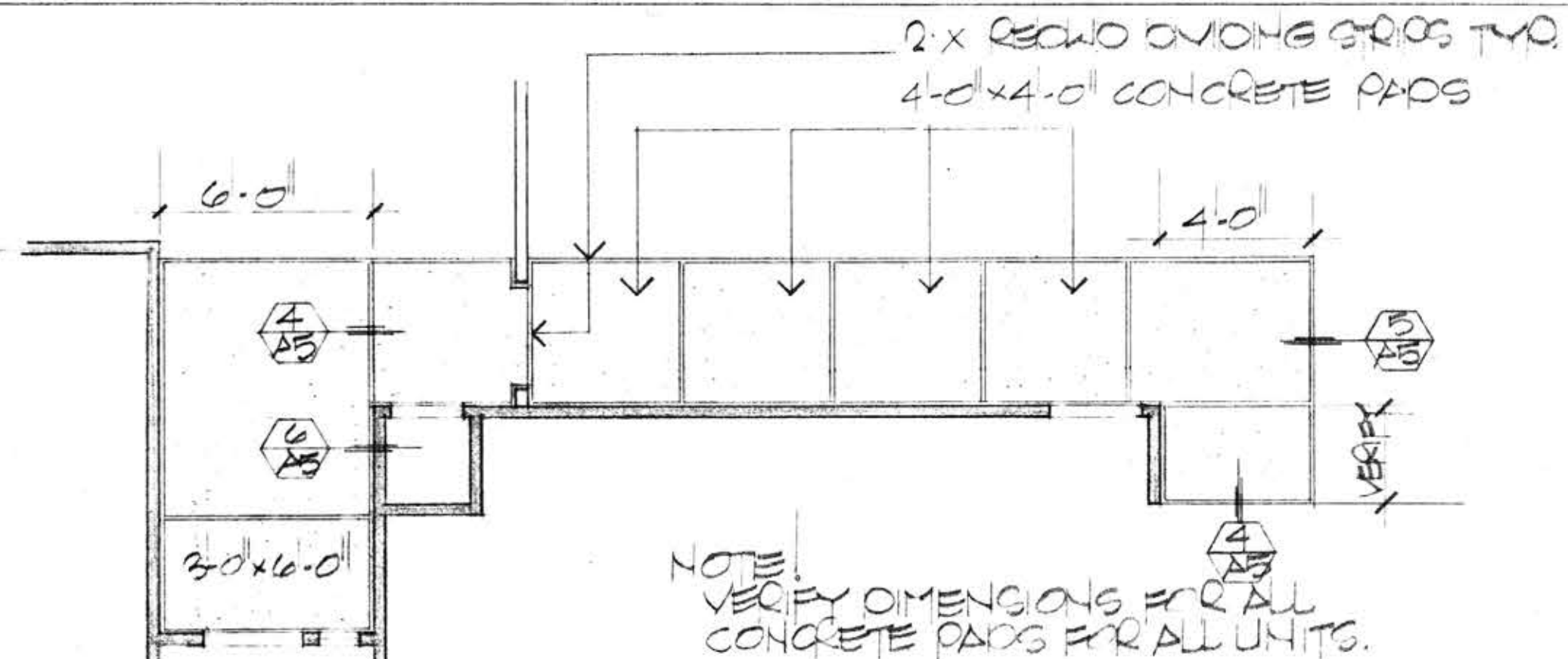

1
AS
UNITS 830 AND 831

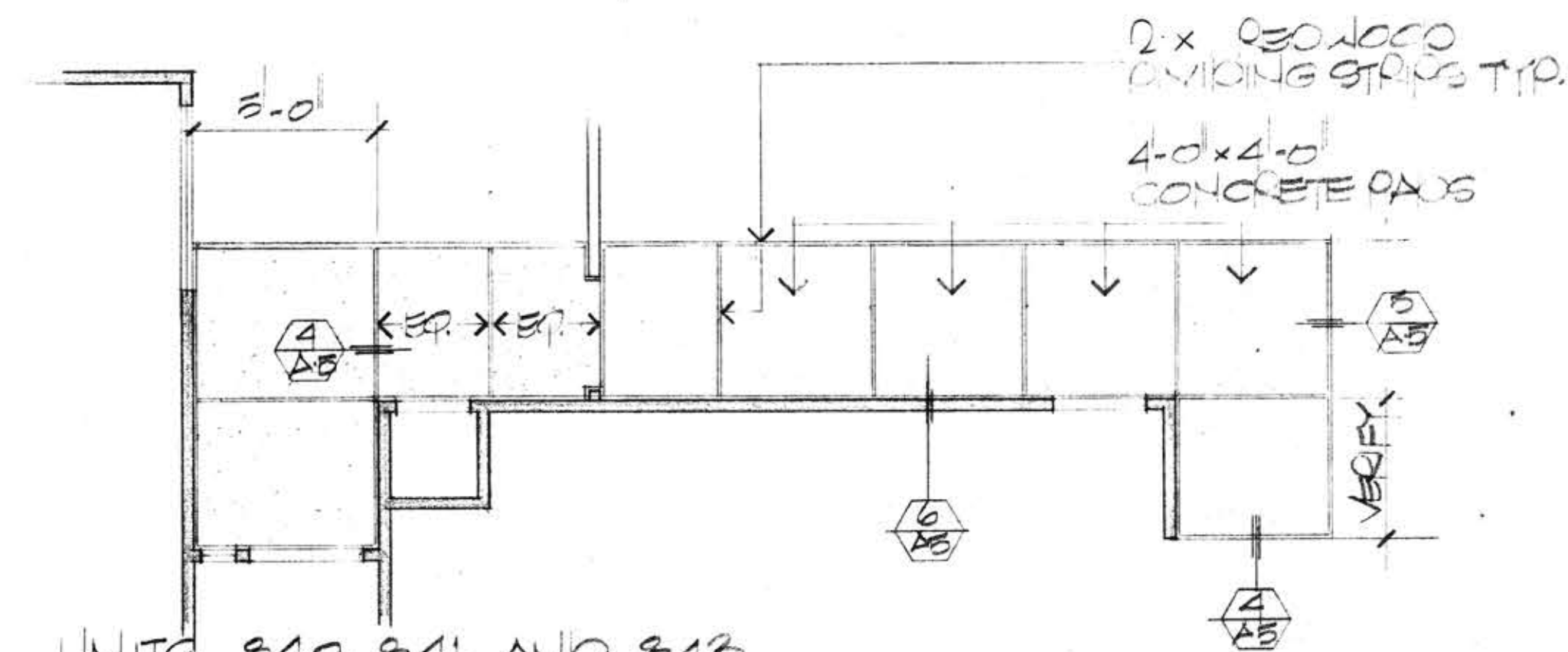

2
AS
UNITS 840, 841, AND 843

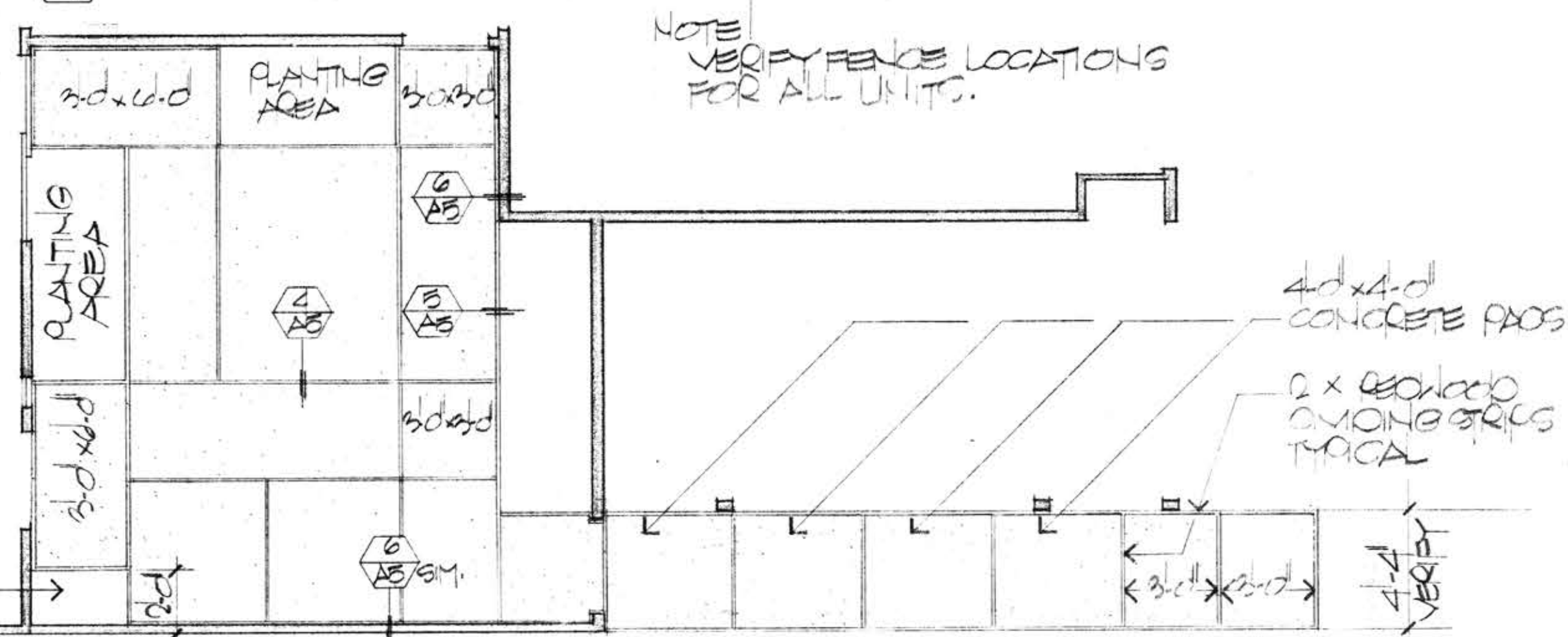

3
AS
UNITS 931 AND 941

JOB NO.
68002
DATE
6-13-69

BALLENA BAY TOWNHOUSES
ALAMEDA CALIFORNIA

FISHER • FRIEDMAN • ASSOCIATES • A.I.A.
ARCHITECTS AND PLANNING CONSULTANTS
20821 J. GERRING A.I.A. • ASSOCIATE
115 CALIFORNIA STREET • SAN FRANCISCO • CALIFORNIA

PAVING PLANS
AND DETAILS

SHEET NO.
A-5