

TYP. BM. TO PILE CONNECTION
4" MAX. TOTAL MISALIGNMENT

(A)
IA

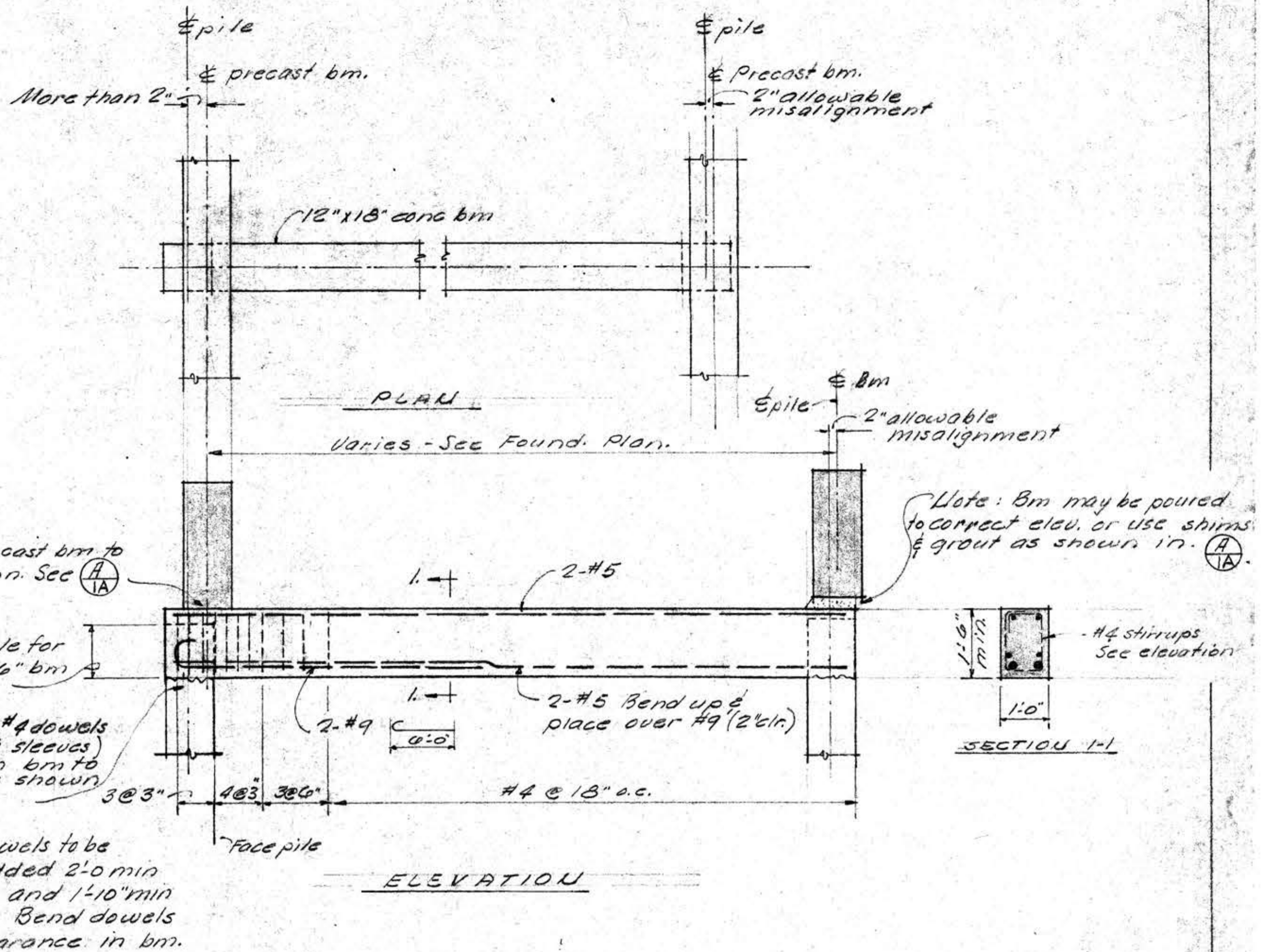

BEAM TO PILE CONNECTION WHERE
MISALIGNMENT EXCEEDS 4" MAX TOTAL.

(B)
IA

NOTE: Pile #27 13" out of alignment Refer Sh 3 Lot 16 Block 3
 Note 5-2x4 studs called for on plan Sh 3.
 Dtl (H) calls for 2-2x10 @ typical 1st floor level. Add 3-2x10
 for total of 5-2x10 @ typical 1st floor level for full
 bearing of 5-2x4 studs.